

F18XOS01

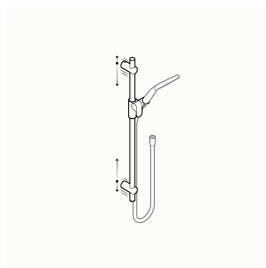

F18XOS03

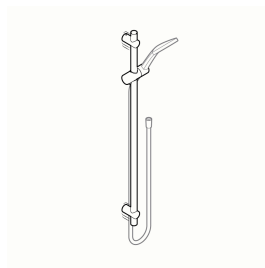

F18XOS21

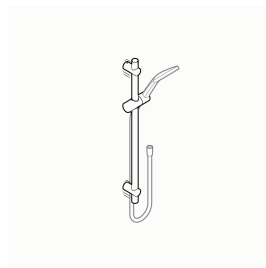

F18XOS23

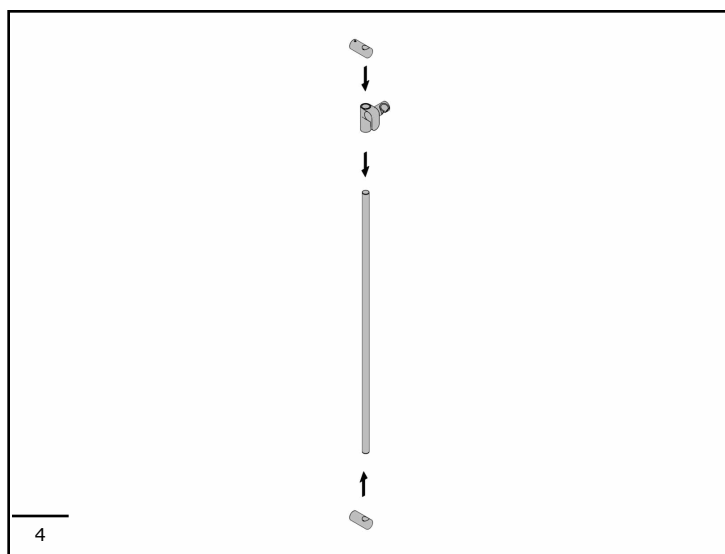
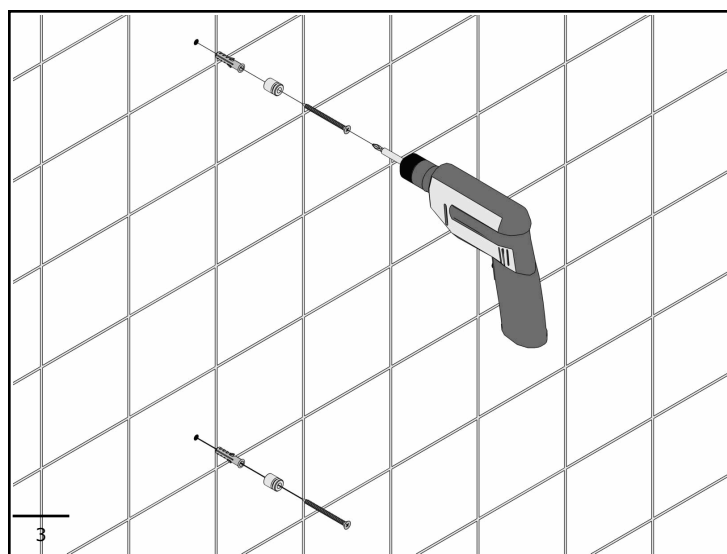
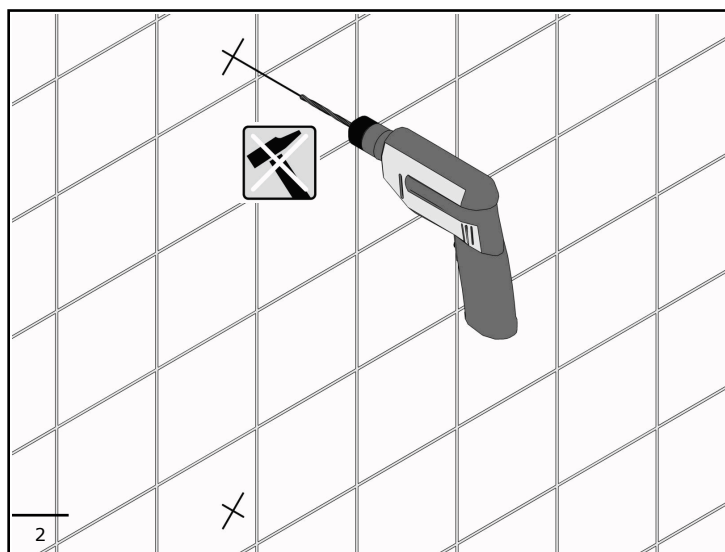
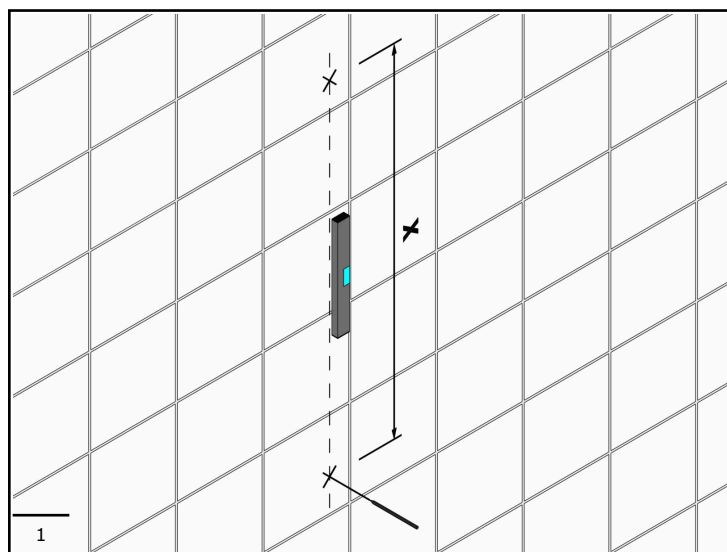

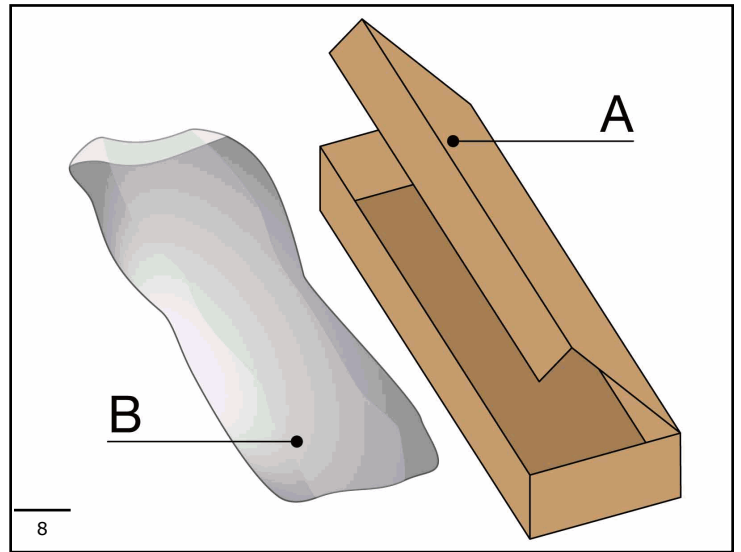
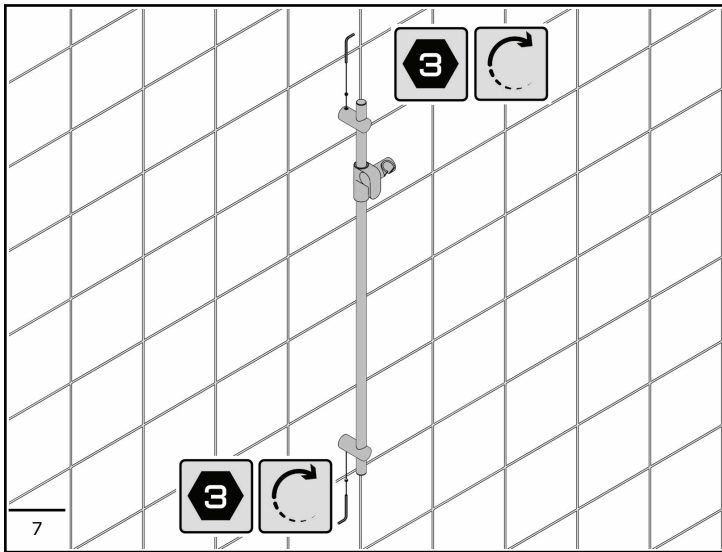
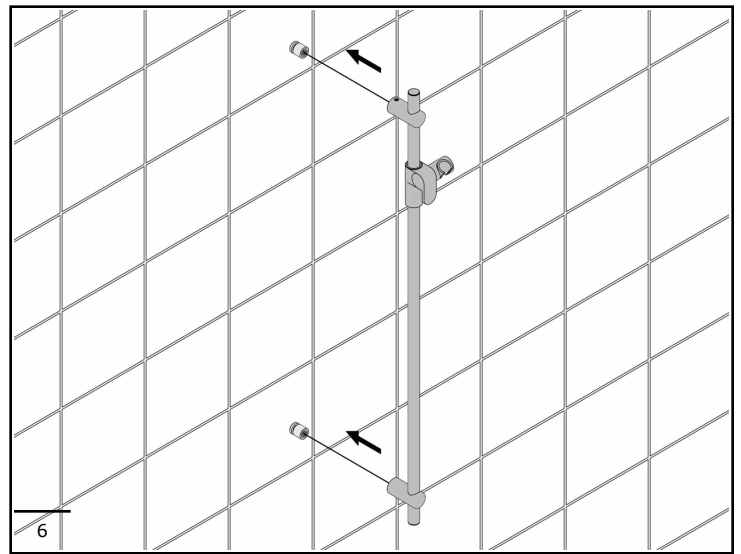
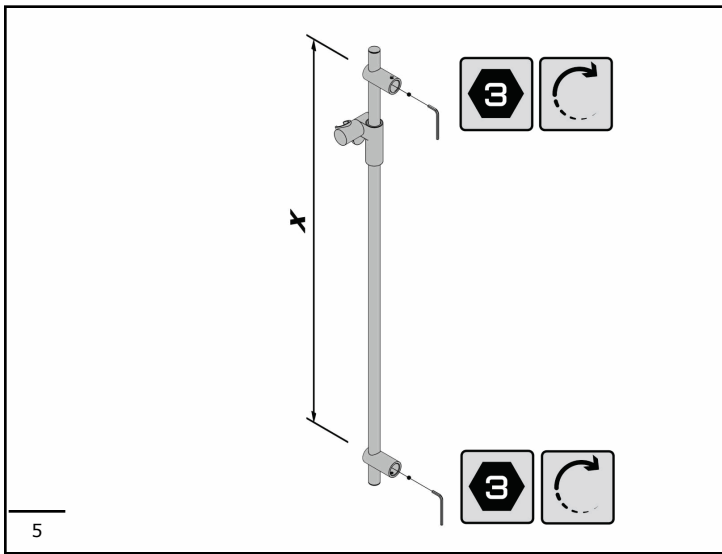

A  
 Packaging Type: Box  
 Coding: PAP 20 - Corrugated cardboard  
 Collection instructions: PAPER

B  
 Packaging type: Sack  
 Coding: LDPE 4 - Plastic  
 Collection instructions: PLASTIC

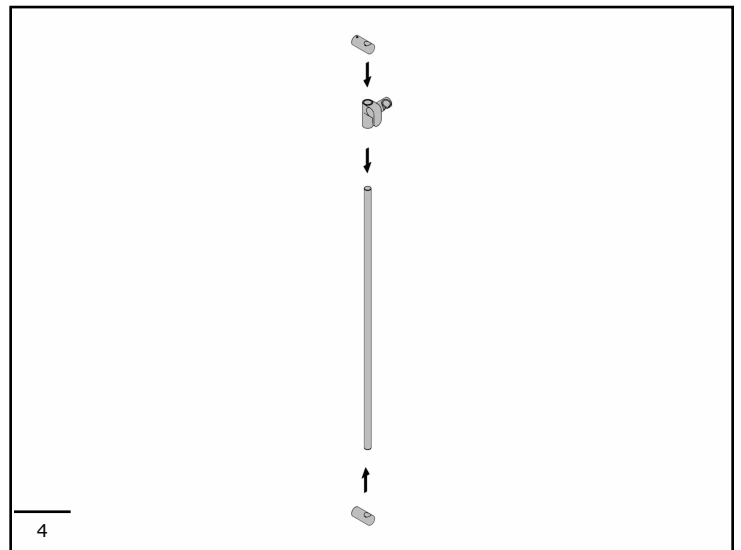
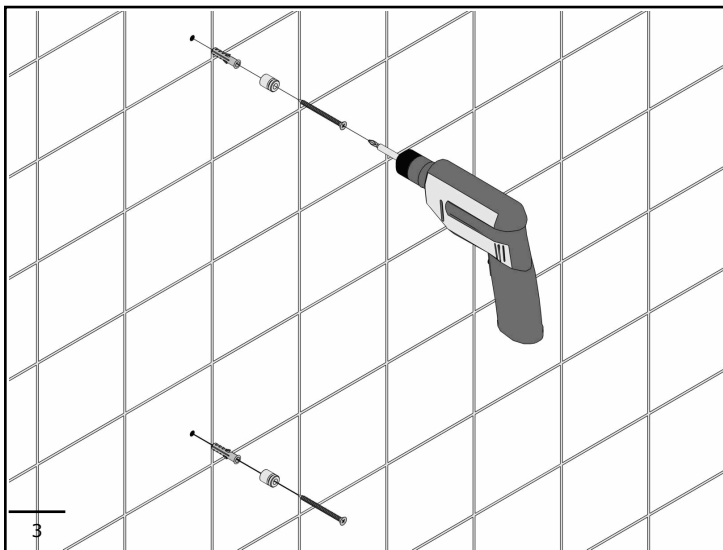
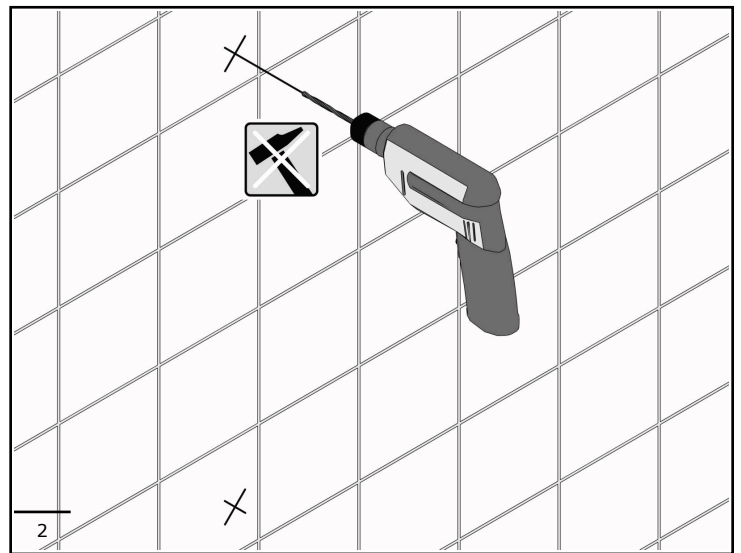
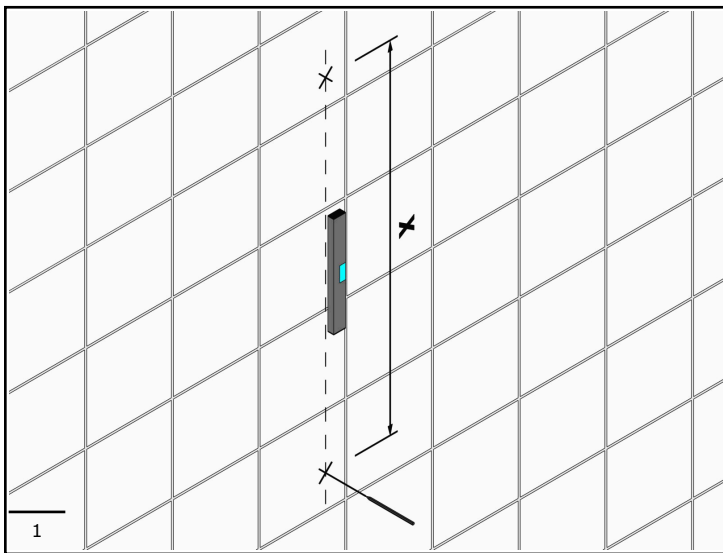
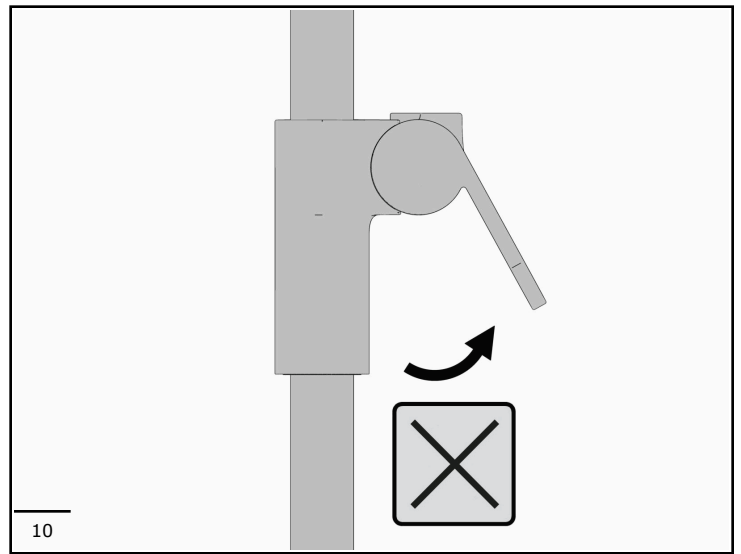
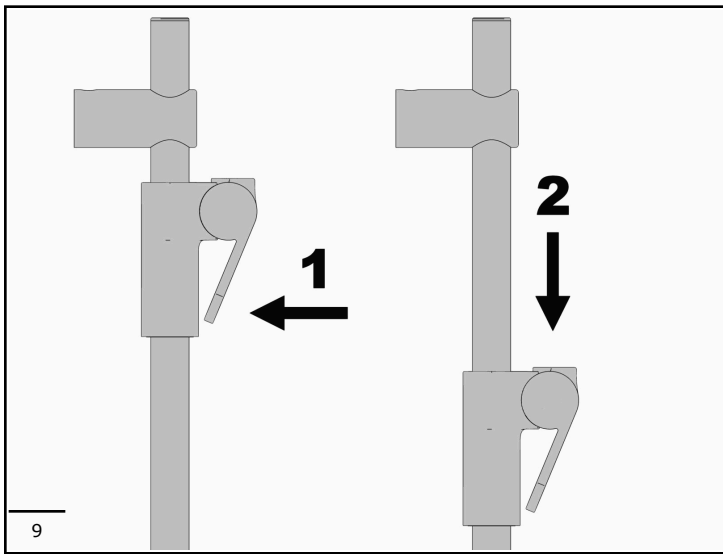

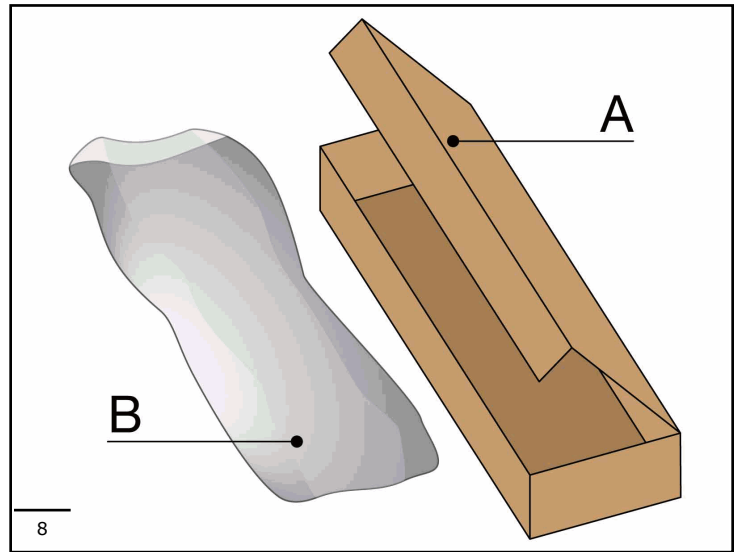
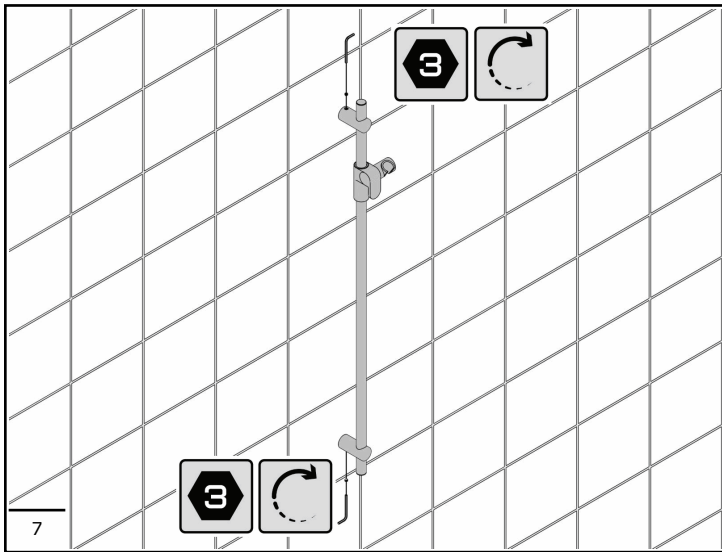
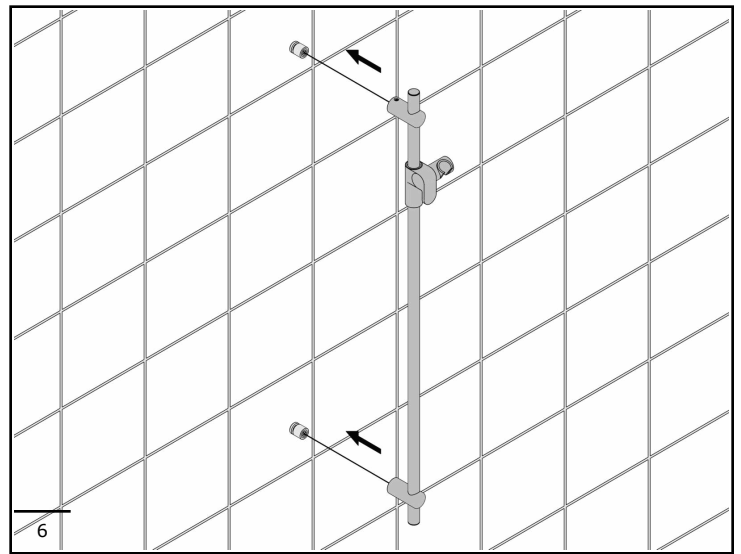
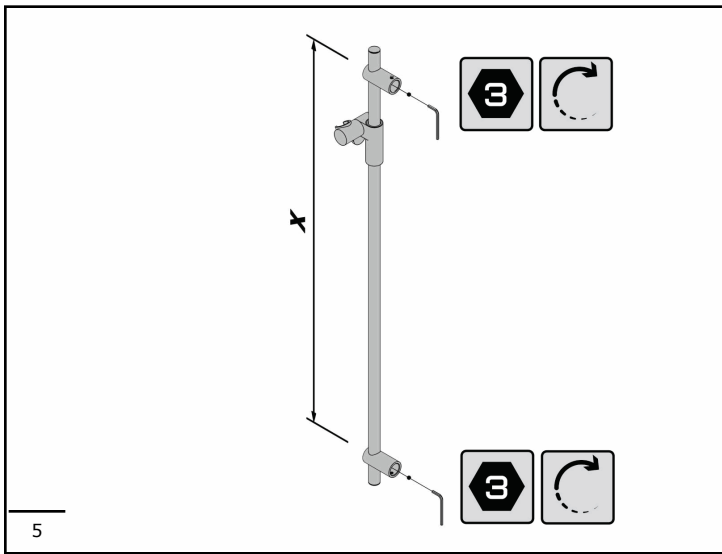

A  
 Packaging Type: Box  
 Coding: PAP 20 - Corrugated cardboard  
 Collection instructions: PAPER

B  
 Packaging type: Sack  
 Coding: LDPE 4 - Plastic  
 Collection instructions: PLASTIC

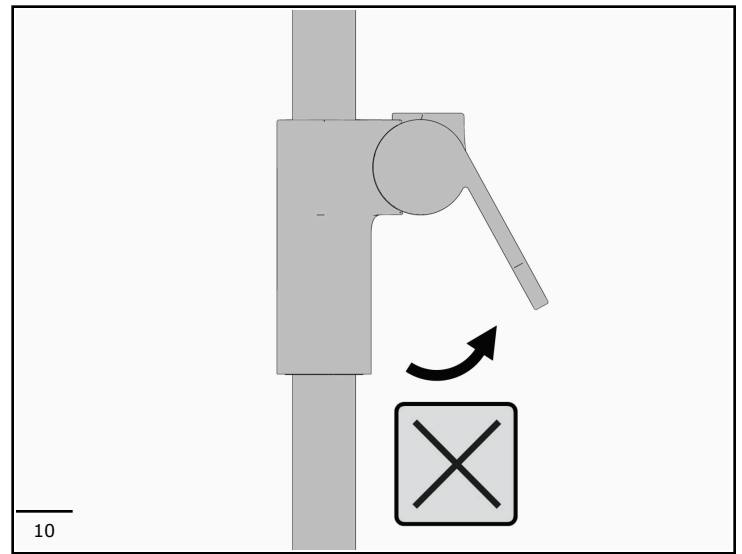
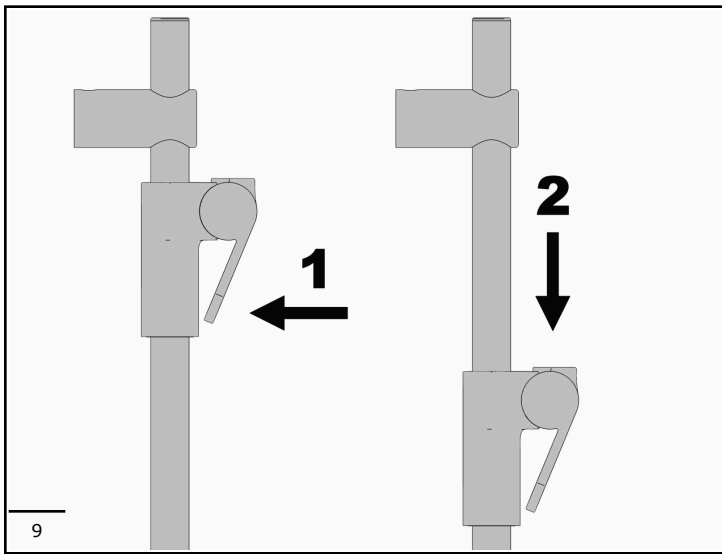

### **INSTRUCTIONS FOR USE OF SHOWER SETS**

The device is a shower set to be used inside the bathroom for the use for which it was designed. Using the device improperly, for example for gymnastics exercises, can cause injuries with serious consequences.

Do not subject the device to loads exceeding for which it was designed.

Exceeding this load can cause permanent damage to the device or harm to people.

To ensure correct use of the device, the latter must be left free of any objects and be easily reachable.

### **GENERAL INFORMATION**

- Keep packaging away from children to avoid risk of suffocation
- All parts of this grab bar are recyclable or reusable. It does not contain carcinogenic, mutagenic or toxic substances.
- This grab bar is capable of withstanding corrosion and temperature variations between 39 to 104 degrees F.

### **SAFETY PRECAUTIONS**

The installation of the device does not present particular difficulties, check that the fixing elements, if supplied, are suitable for the installation wall.

### **MAINTENANCE**

- Check grab bar for proper function prior to first use
- Inspect grab bar at least every 3 months to be sure it is secure and working properly.
- If grab bar becomes unstable, suspend use until it is properly checked by a competent professional.
- Tension hinge can be tightened or loosened, as needed, every time grab bar is inspected.

### **CLEANING/MAINTENANCE**

To clean the column correctly, only use cleaning products that are free of solvents. Strictly avoid the use of detergents containing corrosive substances or acids (hydrochloric acid, acetic acid, phosphoric acid), abrasive sponges and metal pads. We recommend cleaning products specifically designed for cleaning stainless steel.

### **DISPOSAL**

- Recycle unit when removed. All parts are recyclable or reusable.

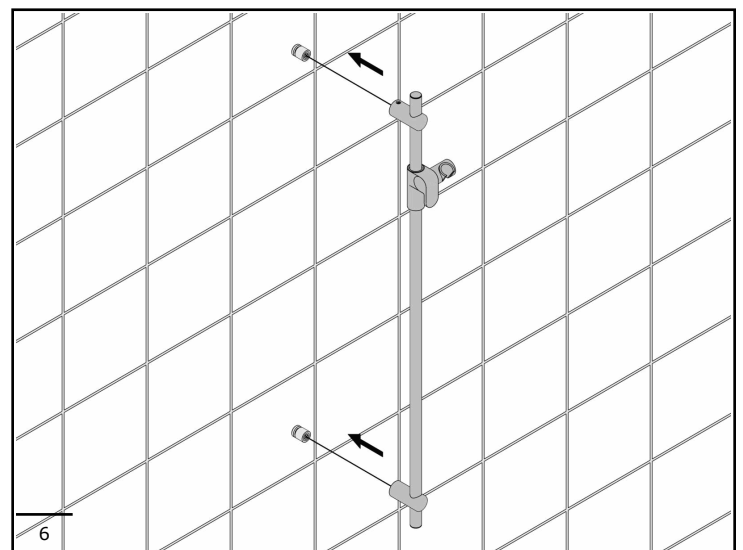
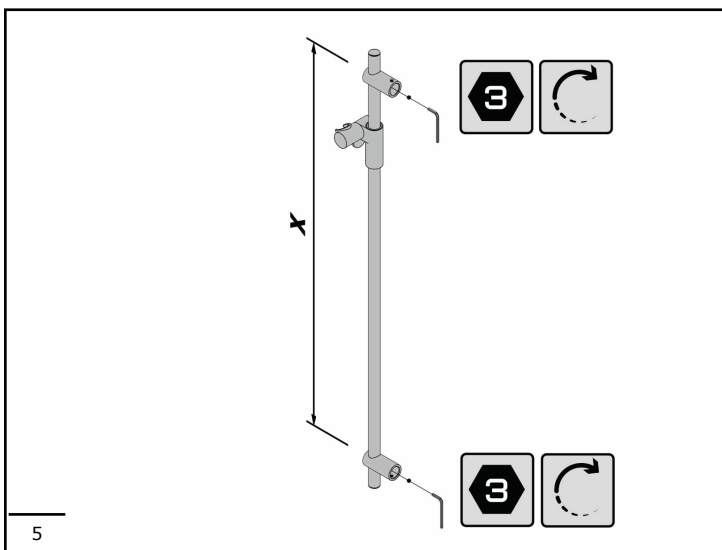
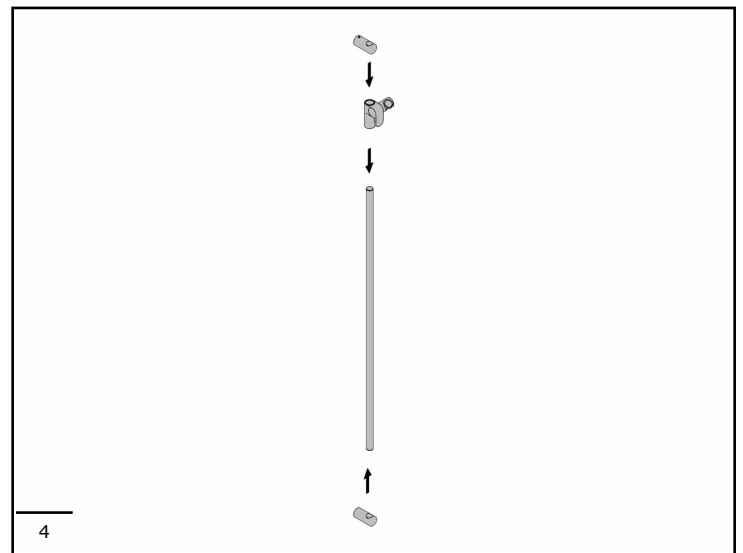
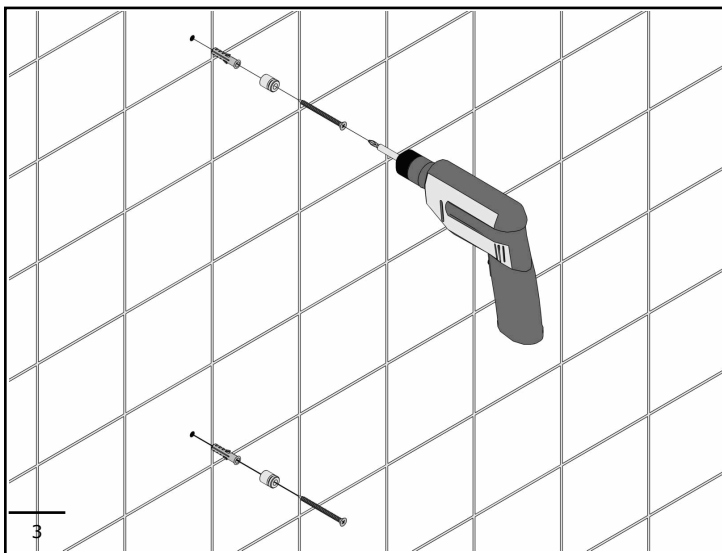
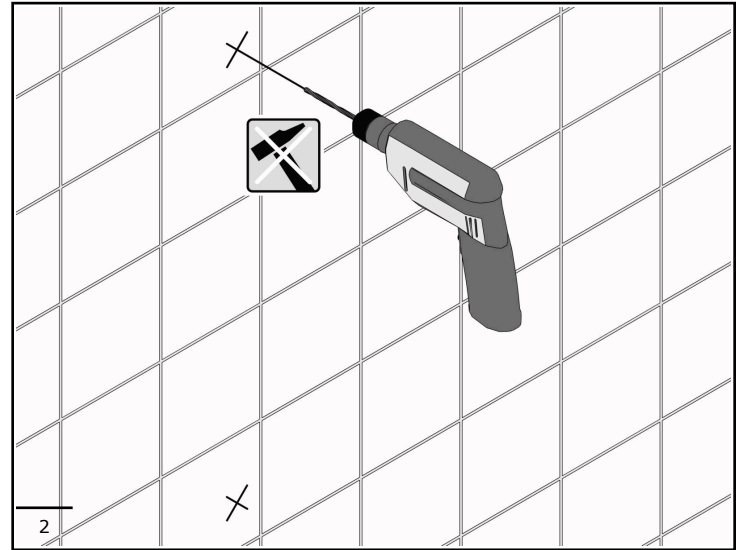
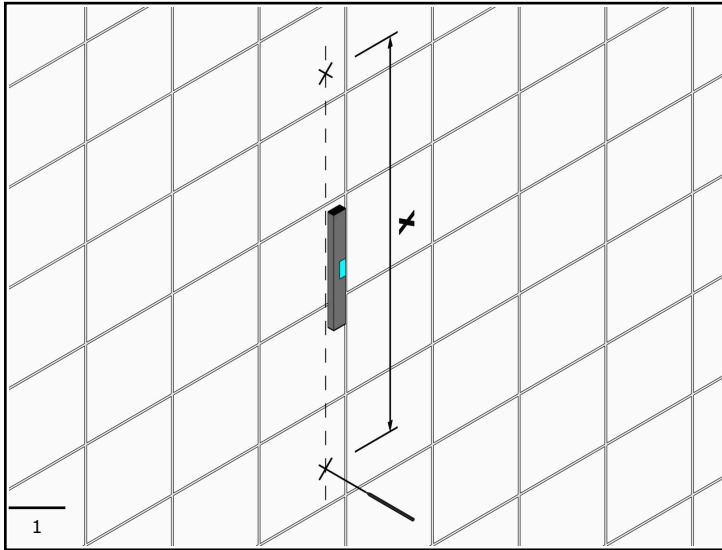

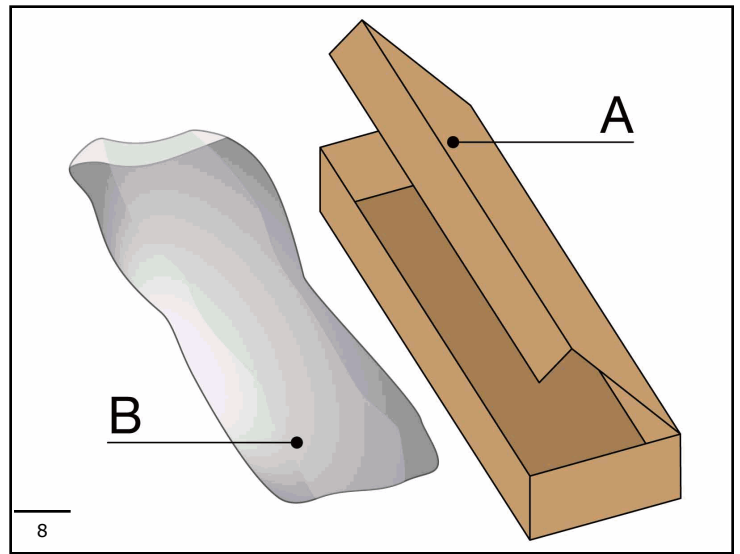
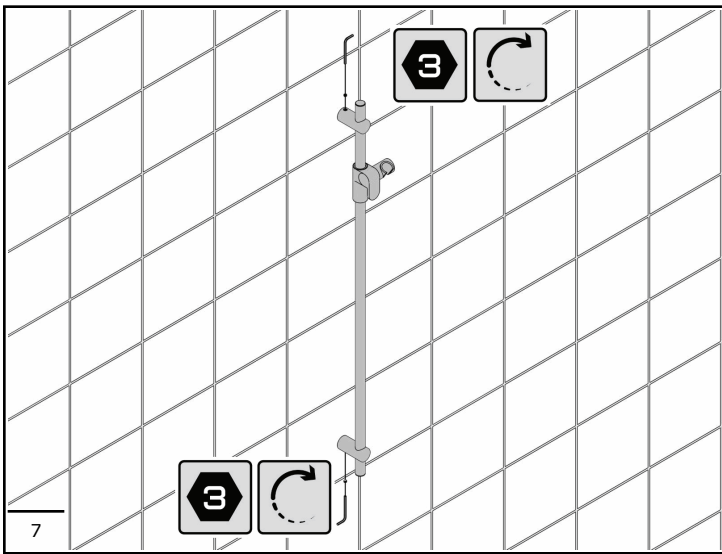

A  
 Packaging Type: Box  
 Coding: PAP 20 - Corrugated cardboard  
 Collection instructions: PAPER

B  
 Packaging type: Sack  
 Coding: LDPE 4 - Plastic  
 Collection instructions: PLASTIC

